





12V Brushless Multifunction Tools

USER MANUAL



Read this manual carefully before using the product to reduce the risk of injury.

SYMBOL DEFINITIONS

	Read the user manual before using this tool.		DANGER! WARNING! CAUTION!
	Always wear safety goggles when using this tool to protect against flying debris. Wear hearing protection, such as earmuffs, to safeguard your hearing. If working in areas with falling object hazards, wear a safety helmet.		Do not expose to rain.
			Wear electrically insulated safety shoes to prevent electric shock.
			Wear gloves to protect your hands.

General Power Tool Safety Warnings

 **WARNING:** Store this manual safely. It includes critical safety and operation instructions for the tool, battery, and charger.

1 WORK AREA SAFETY

- a) Keep the work area clean and well-lit. Cluttered or dark areas invite accidents.
- b) Do not operate power tools in explosive atmospheres (flammable liquids, gases, or dust).
- c) Keep children and bystanders away during operation. Distractions may cause loss of control.

2 ELECTRICAL SAFETY

Do not expose power tools to rain or wet conditions. Water entering a tool increases the risk of electric shock.

3 PERSONAL SAFETY

- a) Stay alert. Do not operate while tired or under the influence.
- b) Always use personal protective equipment—eye protection, dust masks, safety shoes, hard hats, hearing protection.
- c) Maintain balance and footing at all times.
- d) Avoid loose clothing or accessories that can get caught.
- e) Never become complacent. Even experienced users must follow safety

rules.

4 POWER TOOL USE AND CARE

- a) Use the correct tool for the job.
- b) Do not use if the switch malfunctions.
- c) Keep idle tools away from children.
- d) Maintain tools regularly. Replace damaged parts.
- e) Use accessories according to instructions and intended use.

Battery & Charger Safety

1 BATTERY USE

- a) Read all safety and operation instructions before use.
- b) Avoid short circuits; never touch terminals with conductive materials.
- c) Do not expose to moisture or temperatures above 50° C (122° F).
- d) Do not incinerate.
- e) Handle carefully; avoid dropping.
- f) Never use damaged batteries.

2 CHARGER USE

- a) Use only indoors (100–240V AC input).
- b) Plug into the wall outlet before inserting the battery.
- c) Only use with JOHNSWELL 12V batteries.
- d) Damaged chargers must be serviced by professionals.

3 PRECAUTIONS

- a) Never insert foreign objects into terminal slots.
- b) Do not block ventilation.
- c) Charge only within 0–45° C (32–113° F).
- d) Keep away from children.

4 BATTERY DISPOSAL

- a) Do not dispose of lithium batteries with regular waste.
- b) Contact local authorities for recycling procedures.

5 BEFORE RECYCLING

- a) Avoid full discharge.
- b) Charge every 3 months when not in use.

Installation & Operation

- a) Install or remove batteries only when the switch is OFF.
- b) Align and insert attachments securely.
- c) Use the lock switch to prevent accidental startup during installation.
- d) Adjust speed using the dial (7 levels).

Product Specifications

**➤ AD1256
2 IN 1 RATCHET WRENCH
SCREW DRIVER**

- Square Drive Size: 3/8 inch (10 mm)
- Torque Settings: 7 levels
- Max Torque: 35 Newton-meters (Nm)
- No-load Speed: 0-54 / 82 / 102 / 128 / 218 / 284 / 408 RPM



**➤ DG1201
DIE GRINDER / SANDER**

- Chuck Size: 1/4 inch Hex
- Torque Settings: 7 levels
- Max Torque: 45 Newton-meters (Nm)
- No-load Speed: 0-5,578 / 7,275 / 9,097 / 10,841 / 13,099 / 15,017 / 18,075 RPM



**➤ AD1205
ANGLE DISC SANDER**

- Polishing Pad Size: 3 inches (75 mm)
- Torque Settings: 7 levels
- No-load Speed: 0-5,058 / 6,495 / 7,796 / 9,353 / 11,225 / 13,278 RPM



**➤ OS1236
3" / 75MM ORBITAL POLISHER**

- Polishing Pad Size: 3 inches (75 mm)
- Torque Settings: 7 levels
- No-load Speed: 0-2,629 / 3,647 / 4,777 / 5,612 / 6,757 / 7,559 / 11,878 RPM



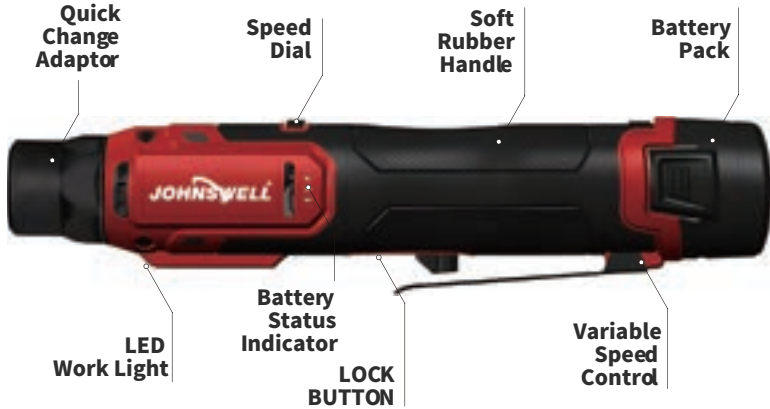

➤ **TB1278**
12V BRUSHLESS MOTOR

- Speed Control
- LED Work Light
- Battery Status Indicator Light
- 2.0 Amp-hour Lithium-ion Battery

Instructions for Use

❶ **LOCK SWITCH (FIG. 1)**

First, push the lock switch downwards to prevent accidental startup of the machine, making assembly operations safer.

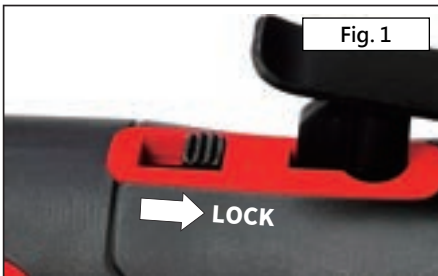

❷ **INSTALLING THE APPROPRIATE HEAD (FIG. 2)**

Choose the appropriate head, pull up the outer head cover, and release the

cover only after confirming that the head attachment is securely in the correct position.



➤ **2-1. DG1201 STRAIGHT GRINDER / SANDER (FIG. 2-1-1 ~ 2-1-2)**

a) Installation: When installing a grinding head/sanding disc, align it with the drive head, then push it in completely until it's securely in place.

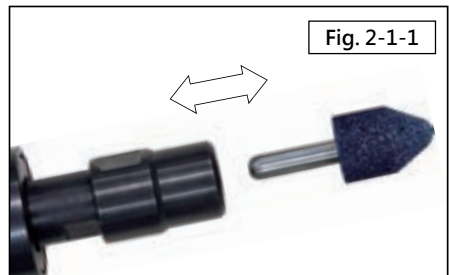

b) Removal: To remove a grinding head/sanding disc, firmly pull it straight out.

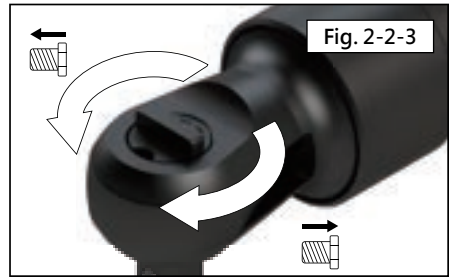
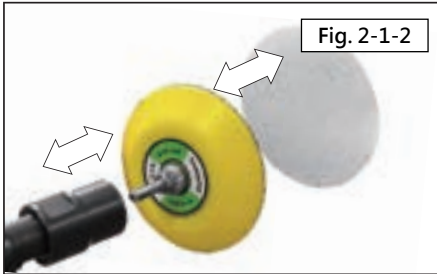

➤ **2-2. AD1256
2-IN-1 RATCHET WRENCH / DRIVER
(FIG. 2-2-1 ~ 2-2-3)**

- a) Installation: To install a socket/driver bit, align it with the square drive head, then push it in completely until it's securely in place.
- b) Removal: To remove a socket/driver bit, firmly pull it straight out.
- c) Forward/Reverse Rotation: This switch determines the rotation direction of the tool (forward or reverse). To change the rotation direction, first stop the tool, then push the forward / reverse switch to the left or right.

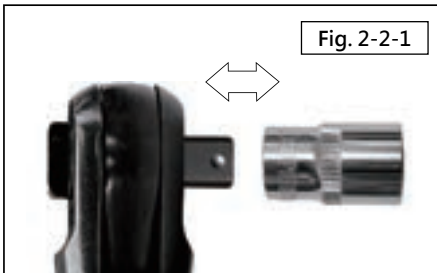

➤ **2-3. OS1236
RANDOM ORBITAL POLISHER
(FIG. 2-3-1 ~ 2-3-3)**

Installation: Prepare the mounting wrench, OS1236 polishing pad, and OS1236 connector. Align them with the drive head, then use the mounting wrench to help screw the polishing pad onto the connector.

⚠ WARNING: Before installing or removing sockets, position the forward/reverse switch in the center to prevent accidental startup and potential hazards.

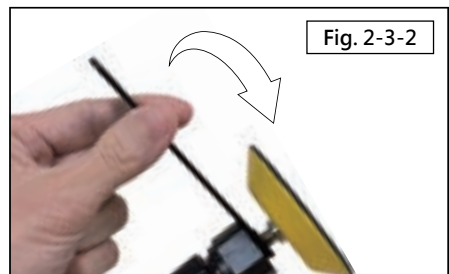
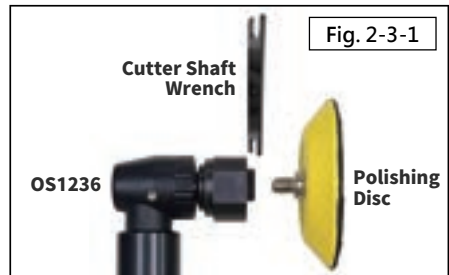

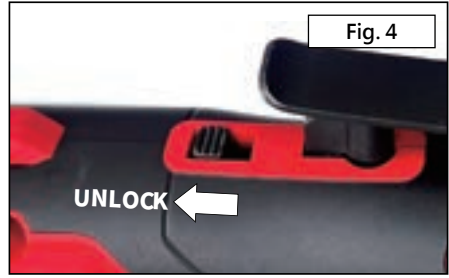
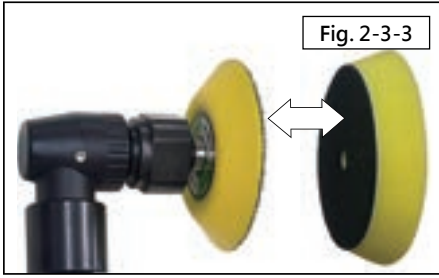

➤ **2-4. AD1205 SANDER (FIG. 2-4)**

Installation: Align the pad with the drive head, then rotate it to click it into the connector.

5 SPEED CONTROL (FIG. 5)

Turn the speed dial to select your desired rotation speed. There are seven speed options available.

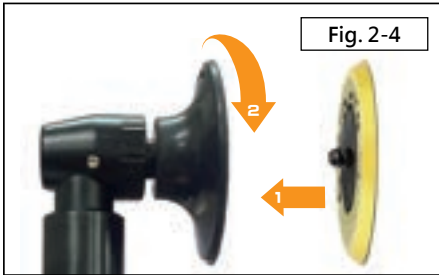

3 INSTALLING THE BATTERY (FIG. 3)

Install the fully charged 12V lithium battery, ensuring the battery is aligned with the tool interface, then push it in until it locks.

6 STARTING THE TOOL (FIG. 6)

To start the tool, simply press the power switch. The harder you press the switch, the faster the tool will operate. Release the switch to stop the tool.

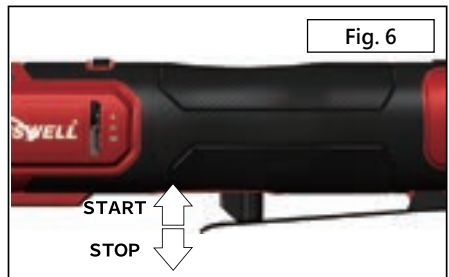

4 UNLOCKING THE SWITCH (FIG. 4)

Push the lock switch upwards to unlock it, which will enable you to start the tool.

7 BATTERY INDICATOR (FIG. 7)

This product is equipped with a power indicator for your convenience to check the battery level at any time.

- a) 3 LEDs: >75%
- b) 2 LEDs: 25%~75%
- c) 1 LED: <25%

- e) Battery degradation and natural disasters are not covered.

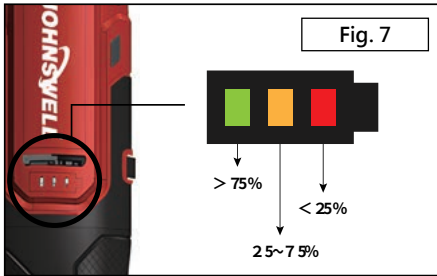

8 TO REMOVE BATTERY (FIG. 8)

Hold both sides, pull downward.



MAINTENANCE

- a) Clean dust regularly.
- b) Never adjust while the tool is running.
- c) Keep away from oil or grease.
- d) Remove battery when not in use.



WARNING: Use only identical replacement parts to avoid hazards.

WARRANTY

- a) 12 months from purchase date.
- b) Proof of purchase required.
- c) Covers material and manufacturing defects only.
- d) Does not cover wear parts, misuse,

JOHNSWELL[®]



JOHNSWELL Electric Co., Ltd.

Address: 2F, No. 270-1, Sec. 2, Zhongyang W. Rd., Zhongli Dist., Taoyuan City, Taiwan

Tel: (03) 492-9589

Fax: (03) 492-6358

Email: sales@johnswellinc.com

Website: <https://www.johnswellinc.com>